

FM200

3.2.1 UNION ADAPTORS

(PART No. 309.002.011/012)

The union adaptor is used to enable pipework to be easily connected to and disconnected from the FM200 container valve outlet adaptor. It is available in two sizes, 25mm and 50mm.

One end (A) is provided with a parallel female thread to provide a compatible joint to the container outlet adaptor. The other end (B) is provided with a female NPT thread to enable pipework to be connected. A swivel joint makes disconnecting containers from the pipework straight forward.

It is recommended that the joint to the container valve is made using PTFE tape.

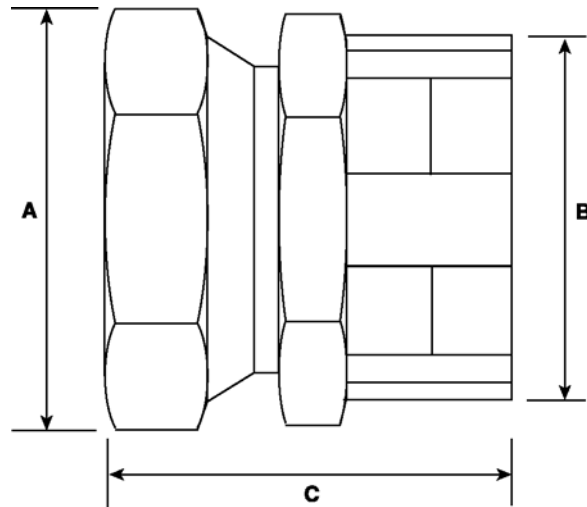

Part No.	Description	A	B	C
309.002.012	50mm Union Adaptor	80	72	80
309.002.011	25mm Union Adaptor	44	63	44