

### 3.3 SOLENOID ACTUATOR - STANDARD

(PART No. 304.205.011/012)

The Solenoid Actuator is used to electrically operate the container valve. The solenoid is operated at 24V d.c. (Current consumption - 0.2 Amps).

It is fitted directly onto the top of the container valve by means of a knurled swivel coupling which enables the unit to be positioned as preferred for electrical connection.

When fitting it is only necessary for the unit to be hand tight.

The solenoid actuator is normally fitted to the container designated as the Master. The actuator is an electro-mechanical device which when energised causes the central pin to move downwards opening the schrader valve in the container valve.

#### FITTING THE SOLENOID AND RESETTING AFTER ACTIVATION

Prior to fitting the solenoid for the first time or after activation during commissioning, maintenance or following a fire, a check must be made to ensure that **CENTRAL ACTIVATION PIN IS PRESSED BACK** until it is below the level of the fixing ring. **FAILURE TO ENSURE THAT THE PIN IS PROPERLY RE-SET PRIOR TO FITTING THE SOLENOID TO THE FM200 CONTAINER VALVE WILL RESULT IN THE IMMEDIATE OPERATION OF THE VALVE AND A POTENTIALLY HAZARDOUS RELEASE OF AGENT.**

The power lead fitted with a DIN plug for connecting to the solenoid is to be ordered separately (Part No. 304.001.001).

The lead is fitted with a diode and has three wires:

Red -	Positive
Blue -	Negative
Green -	Earth

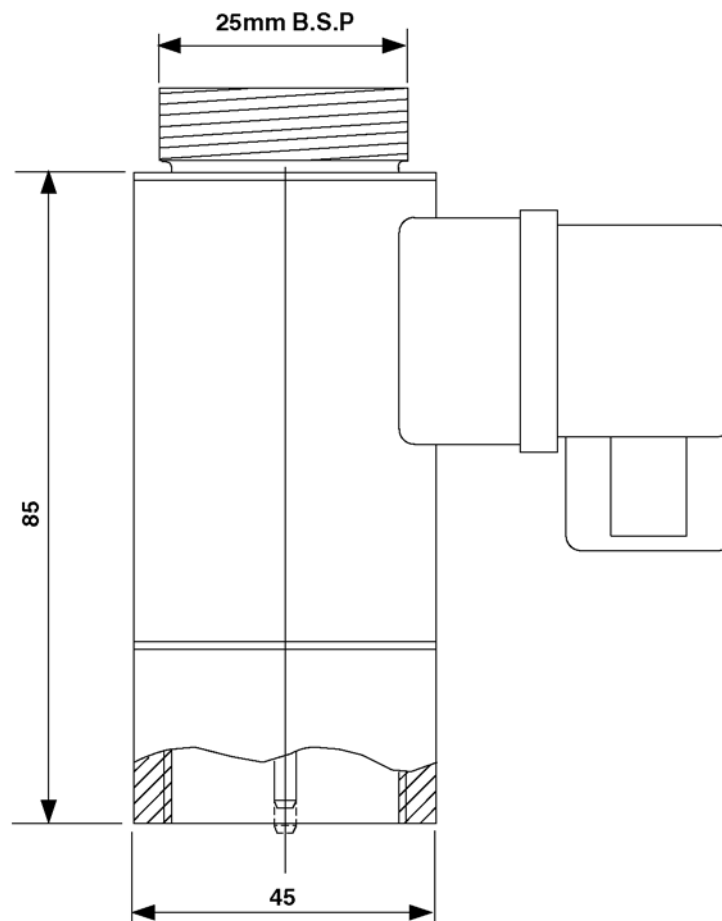

Part No. 304-205-001 Solenoid Actuator