



### DESCRIPTION

Flexible couplings are designed to transmit torque while permitting some radial, axial and angular misalignment. Flexible couplings can accommodate angular misalignment up to a few degrees and some parallel misalignment.

Sizes available: 1" - 10"  
Working pressure: 300 PSI / 2068 Kpa

### MATERIAL SPECIFICATIONS

- **Housing:**  
Ductile iron conform to ASTM A536
- **Coating:**
  - Galvanized
  - Red paint coating: RAL 3000
- **Rubber gasket:**  
EPDM gaskets dispose of the international certifications and have undergone the aging test at 110°C (230°F) during a period of 45 days (1080 hours) and the frozen test at -40°C (-40°F) during a period of 4 days (96 hours).  
Working temperature gaskets: -34°C to 110°C (-29°F to 230°F).
- **Bolts and Nuts:**  
Medium carbon steel, threaded BSPT, zinc electroplated, quenched and tempered.

### DEFLECTION ANGLE AND GAP BETWEEN TWO PIPES

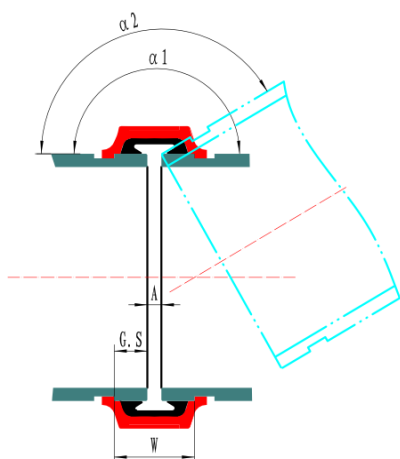

Reference		Size	O.D.	DN	W	G.S (mm)			Gap between two pipes (A) (mm)		Max deflection angle (mm)
Red	Galva	Inch	mm	mm	mm	Basic	Max.	Min.	Max.	Min.	
GKFR	GKFG	1	33,7	25	34	15,88	16,64	15,12	3,76	0,72	2,3
GKFR	GKFG	1¼	42,4	32	34	15,88	16,64	15,12	3,76	0,72	2,3
GKFR	GKFG	1½	48,3	40	34	15,88	16,64	15,12	3,76	0,72	2,3
GKFR	GKFG	2	60,3	50	35	15,88	16,64	15,12	4,76	1,72	2,3
GKFR	GKFG	2½	76,1	65	35	15,88	16,64	15,12	4,76	1,72	1,9
GKFR	GKFG	3	88,9	80	35	15,88	16,64	15,12	4,76	1,72	1,6
GKFR	GKFG	4	114,3	100	36	15,88	16,64	15,12	5,76	2,72	1,6
GKFR	GKFG	5	139,7	125	37	15,88	16,64	15,12	6,26	3,22	1,3
GKFR	GKFG	6	168,3	150	38	15,88	16,64	15,12	7,26	4,22	1,1
GKFR	GKFG	8	219,1	200	44	19,05	19,81	18,29	6,92	3,88	0,8
GKFR	GKFG	10	273,0	250	47	19,05	19,81	18,29	10,42	7,38	0,7

The actual gap between the pipes may change according to the actual cut and roll groove.  
Extra degrees of deflection angle are allowed for flexible couplings, but when the flexible coupling is assembled, the value must be no more than the maximum degree.

### DIMENSIONS

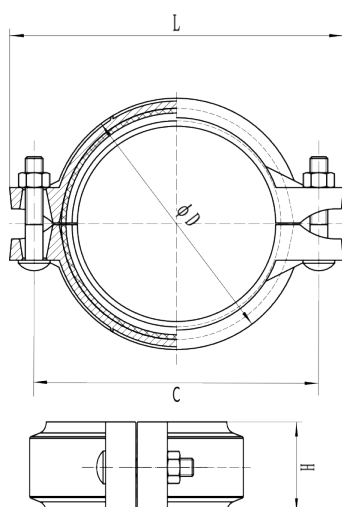

Reference		Size	O.D.	DN	Nominal dimensions				Bolt Size (d1 x L)	Nuts	Socket wrench	Weight
Red	Galva	Inch	mm	mm	ØD mm	L mm	H mm	C mm	mm	mm	kg	
GKFR	GKFG	1	33,7	25	55	97	45	73	M10*40	21,8	15	0,42
GKFR	GKFG	1¼	42,4	32	63,5	107,5	45	84	M10*50	21,8	15	0,48
GKFR	GKFG	1½	48,3	40	69	114	45	90	M10*50	21,8	15	0,53
GKFR	GKFG	2	60,3	50	83,6	124	46	102	M10*60	21,8	15	0,68
GKFR	GKFG	2½	76,1	65	98	139	46	115	M10*60	21,8	15	0,80
GKFR	GKFG	3	88,9	80	114	156	46	132	M10*60	21,8	15	0,95
GKFR	GKFG	4	114,3	100	142	189	50	162	M12*70	26,0	18	1,44
GKFR	GKFG	5	139,7	125	170	222	50	192	M12*70	26,0	18	1,91
GKFR	GKFG	6	168,3	150	198	251	50	222	M12*70	26,0	18	2,10
GKFR	GKFG	8	219,1	200	260	322	58	282	M16*85	34,5	24	3,77
GKFR	GKFG	10	273,0	250	319	393	64	352	M20*110	42,8	30	6,54